

INSTALLATION INSTRUCTIONS				Description
Part No	1463203000	Date	17.01.2007	ASSEMBLY INSTRUCTIONS FOR : 1463171000 CARPET KIT
Page	1	Release	0	
Issued	R & D	Machine Type	SW 750 Terra 28B Edge 28B Floortec 350	
Name	D.B.	Product Index	F-23.3.5	

PROCEDURA DI INSTALLAZIONE - ASSEMBLY PROCEDURE

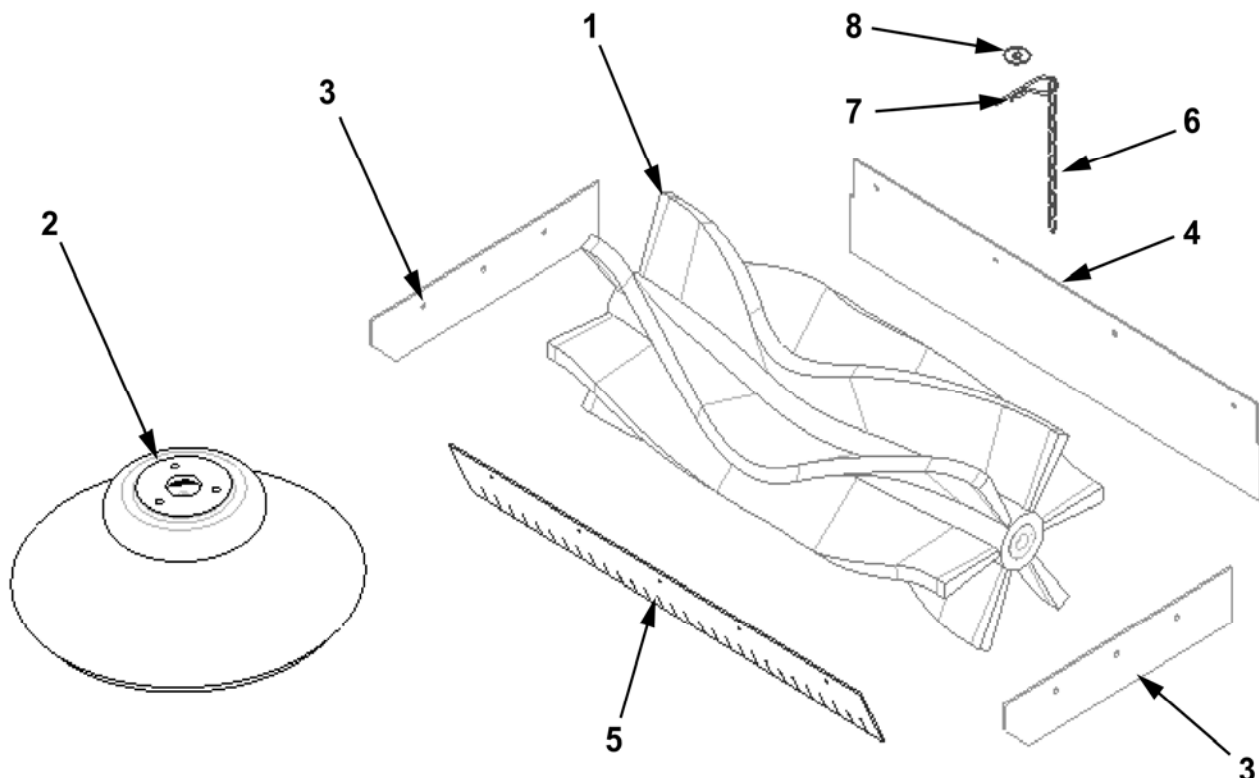

Contents of Kit / *Contenuto del Kit*

ITEM/ <i>Pos.</i>	QTY/ <i>Quantita</i>	DESCRIPTION/ <i>Descrizione</i>
1	1	Main Broom Ø180x500 Nylon / <i>Spaz. Centt .Ø180x500 Nylon</i>
2	1	Side Broom 109x315 Nylon / <i>Spaz. Lat. 109x315 Nylon</i>
3	2	Non-marking Side Skirt / <i>Flap Laterale Antitraccia</i>
4	1	Non-marking Rear Skirt/ <i>Flap Posteriore Antitraccia</i>
5	1	Non-marking Dirt Container Skirt / <i>Flap Cassetto Rifiuti Antitraccia</i>
6	1	Chain / <i>Catane</i>
7	1	Split pin / <i>Copiglia</i>
8	1	Washer 8x24 / <i>Rondella 8x24</i>
9	1	Carpet Kit Instructions / <i>Istruzioni Kit Moquette</i>

INSTALLATION INSTRUCTIONS				Description
Part No	1463203000	Date	20.10.2004	ASSEMBLY INSTRUCTIONS FOR : 1463171000 CARPET KIT
Page	2	Release	0	
Issued	R & D	Machine Type	SW 750 Terra 28B Edge 28B Floortec 350	
Name	D.B.	Product Index	F-23.3.5	

PROCEDURA DI INSTALLAZIONE - ASSEMBLY PROCEDURE

Refer to the Users Manual for the assembling of the skirts and brooms.
Fare riferimento al Manuale d'Uso per il montaggio dei flap e delle spazzole.

Chain assembling / Montaggio catena

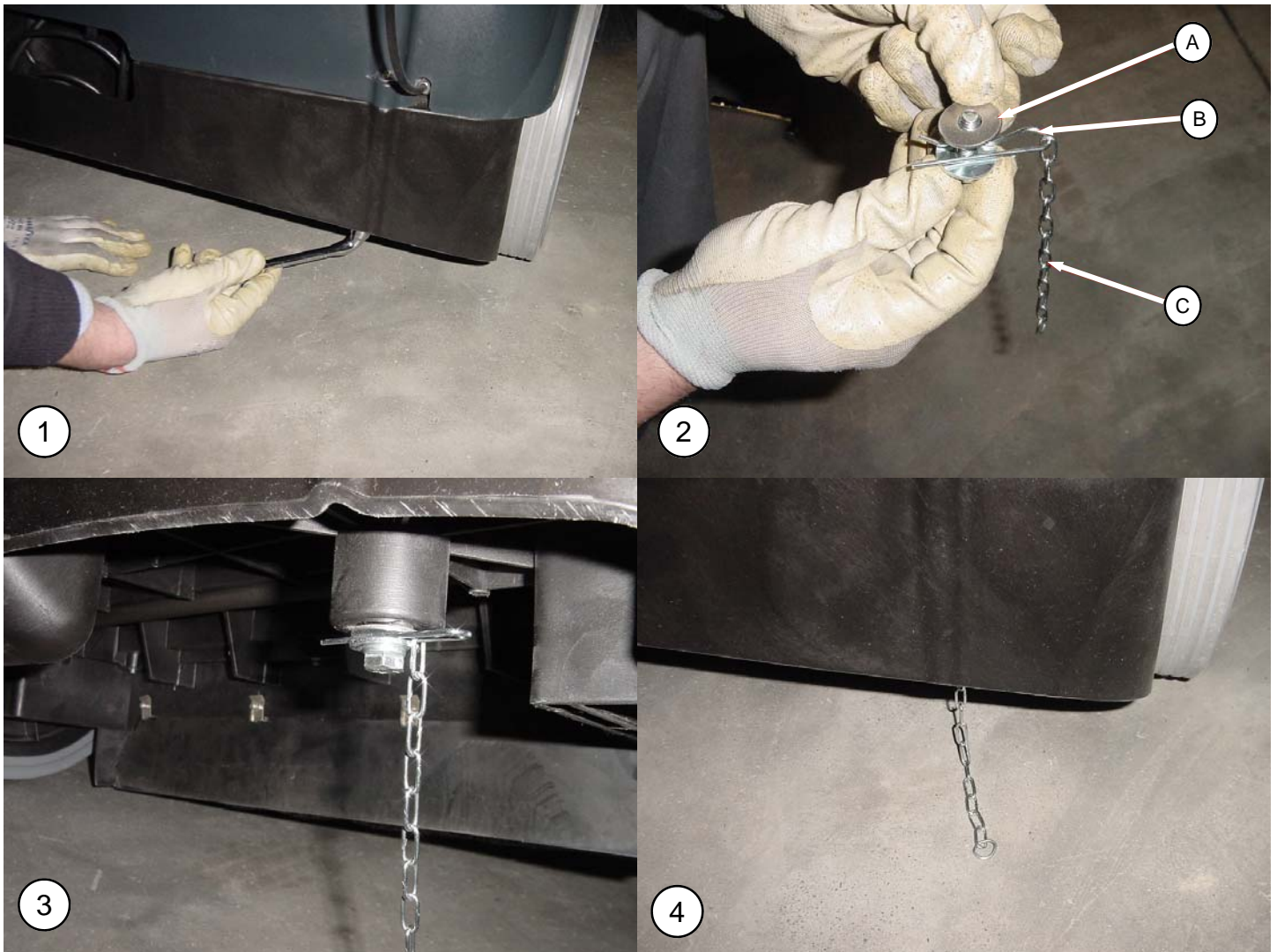

- 1) Rimuovere una delle due viti di fissaggio del maniglione al telaio.
Remove one of the two screws that hold the handle-bar onto the chassis.
- 2) Posizionare copiglia (B), catena (C) e rondella (A) fornite, come da figura.
Position split-pin (B), chain (C) and washer (A) supplied, as shown in figure.
- 3) Riavvitare la vite nella sua sede.
Replace the screw in the own seat.
- 4) Montaggio ultimato.
Completed assemblage