

56507034- Work Light Kit

For Exterra™ Models: All
SR 1900: All

CONTENTS OF KIT

ITEM	PART NO.	QTY	DESCRIPTION
	56040897	1	Instruction Sheet
1	56002192	3	Scr, Pan Phil 10-24 x .75
2	56002768	3	Nut, Hex Nyl Loc 10-24
3	56003711	12	Scr, Pan Phil SS Plastite 10-14 x 0.62
4	56507678	1	Harness, Curb Light
5	56172017	4	Clamp, P
6	56305626	1	Bracket, Light Mount
7	56305627	1	Trouble Lamp
8	56507830	2	Lamp 12v
9	56508468	1	Bracket, Work Light Mounting
10	56507834	1	Bracket, Light Mount
11	56507676	1	Harness, Rear Work Light
12	56507677	1	Harness, Trouble Light
13	56478246	10	Tie, Cable
14	56760212	1	Grommet

INSTALLATION INSTRUCTIONS



WARNING!

Make sure the Hopper Safety Support is in place whenever attempting to do any maintenance work under or near the raised hopper. The Hopper Safety Support holds the hopper in the raised position to allow work to be performed under the hopper. NEVER rely on the machine's hydraulic components to safely support the hopper.

- 1 Start the engine. Raise the hopper to the full up position. Pull back on the hopper safety support handle to engage the hopper safety support, then lower the hopper slightly to secure. Set the parking brake. Turn off the engine.

⚠ WARNING!

Make sure the Hopper Safety Support is in place whenever attempting to do any maintenance work under or near the raised hopper. The Hopper Safety Support holds the hopper in the raised position to allow work to be performed under the hopper. NEVER rely on the machine's hydraulic components to safely support the hopper.

- 2 See Figure 1. Remove the top five Wing Nuts and Washers (A) that secure the Rubber Cover (B) to the frame. Fold the rubber cover down to access the Electrical Connector (C) and grounding Screws (D).

This kit contains three separate lights. Installation instructions are separated by each light.

FIGURE 1

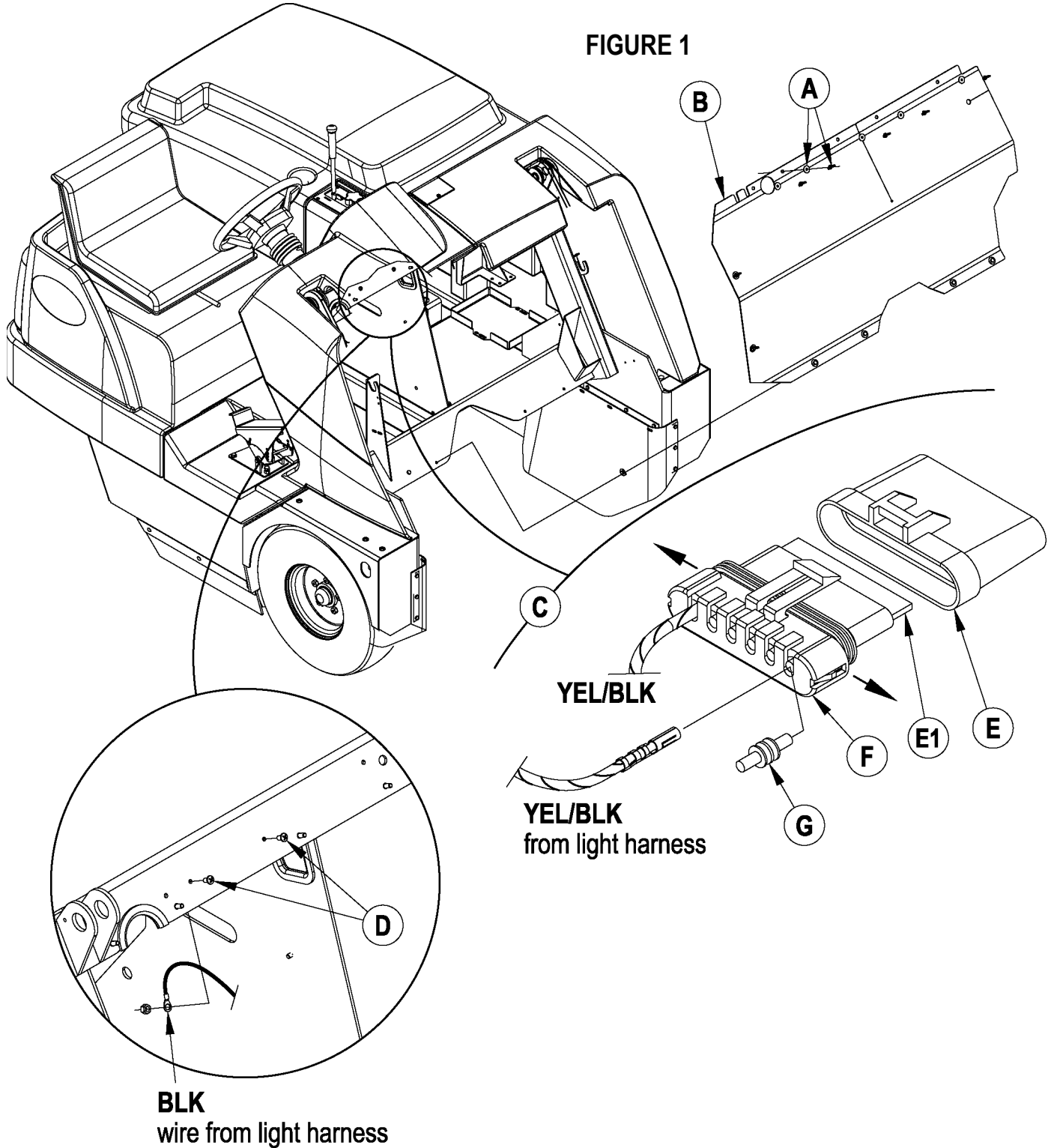

Curb Light Installation

- 3 See Figure 2. Place the Work Light Mounting Bracket (9) onto the machine at the location shown (use the dimensions listed below). Mark the hole locations and drill the four mounting holes using a $\text{Ø} .175-.185$ " drill. Only drill through the outer layer of the roto-molded body panel.
- 4 Mount the bracket to the machine using four of the Screws (3).
- 5 Mount one of the Work Lights (8) to the top of Bracket (9).
- 6 Plug in the end of the electrical harness (4) to the work light harness. Go to step 7 on the next page.

FIGURE 2

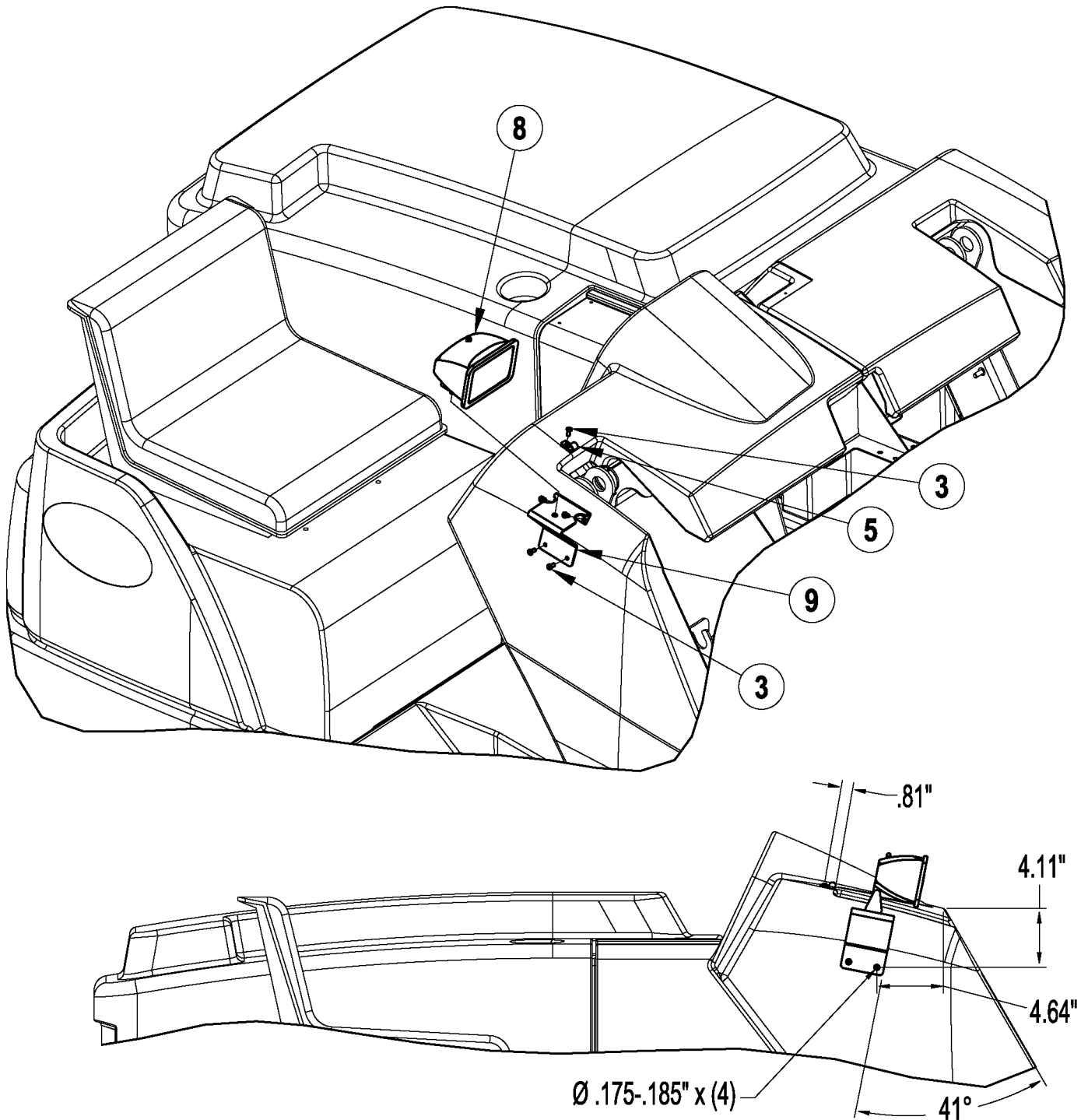

Curb Light Installation (continued)

- 7 See Photo 1 and Photo 2. Route the electrical wiring harness down behind the hydraulic hoses as shown.
- 8 See Figure 1. Remove the Screw and Nut (D) and use it to secure the ring terminal on the BLK wire and all other wires which were grounded at this location.
- 9 Locate the wire connector (C), slide off its Cover (E) and remove the Bus Bar (E1). Pull on the sides of the Cap (F) and slide the cap off of the connector. Remove one of the green dummy Plugs (G). Insert the pin on the end of the YEL/BLK wire into the now open slot, and reinstall the cap to lock the wire in place. Then reinstall the bus bar and cover onto the connector.
- 10 Secure the wiring harness (4) to the machine using one of the P-Clamps (5) and Screws (3) as shown in Photo 1 (drill a Ø.175-.185" pilot hole for the screw).

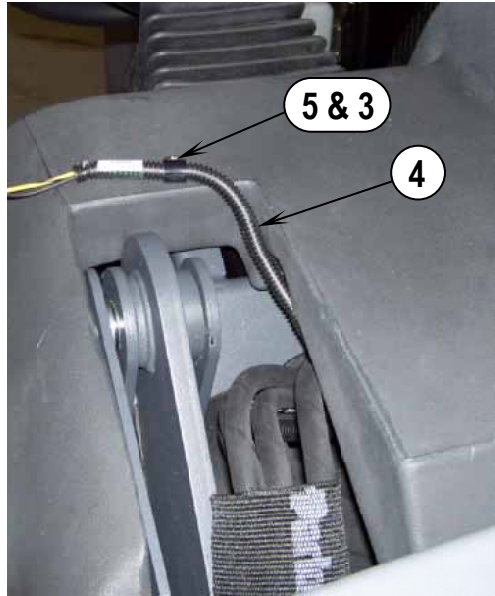

PHOTO 1

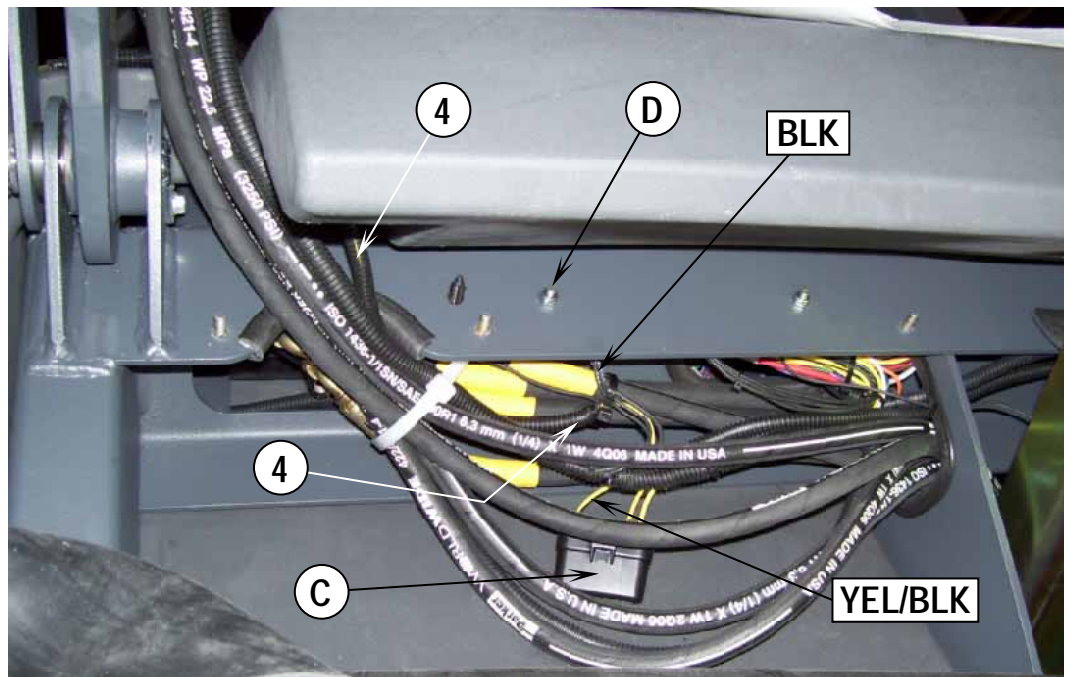
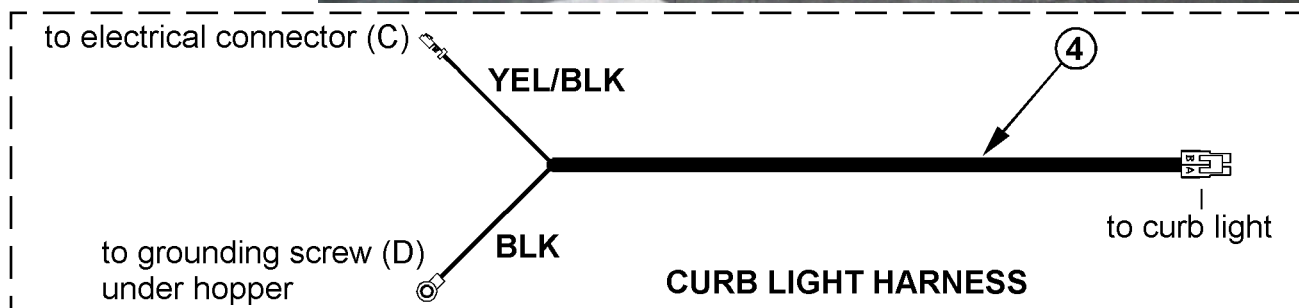

PHOTO 2



Rear Work Light Installation

- 11 See Figure 3. Mount the remaining Work Light (8) to the top of Light Mount Bracket (10).
- 12 Place the bracket and light onto the engine cover at the location shown, approximately 11.88 inches from the side of the engine cover. Mark the hole locations and drill the two mounting holes using a $\text{\O} .175\text{-}.185\text{'}$ drill. Only drill through the outer layer of the roto-molded body panel.
- 13 Drill a $\text{\O} 1.00\text{'}$ hole into the rear engine cover at the location shown. Drill through both layers of the roto-molded cover, but not the insulation inside the cover. Install Grommet (14) into this new hole.
- 14 Unlatch and flip open the seat assembly, and swing back the rear engine cover. Then unlatch and lift up to remove the Center Cover Assembly (J), be aware of the engine air intake hose which passes through the cover assembly.

NOTE: Cab Models Only

To open the engine cover: Open the window. Pull the pins on the window latches to fully open the window. Unlatch and swing open the rear window. Then swing back the rear engine cover.

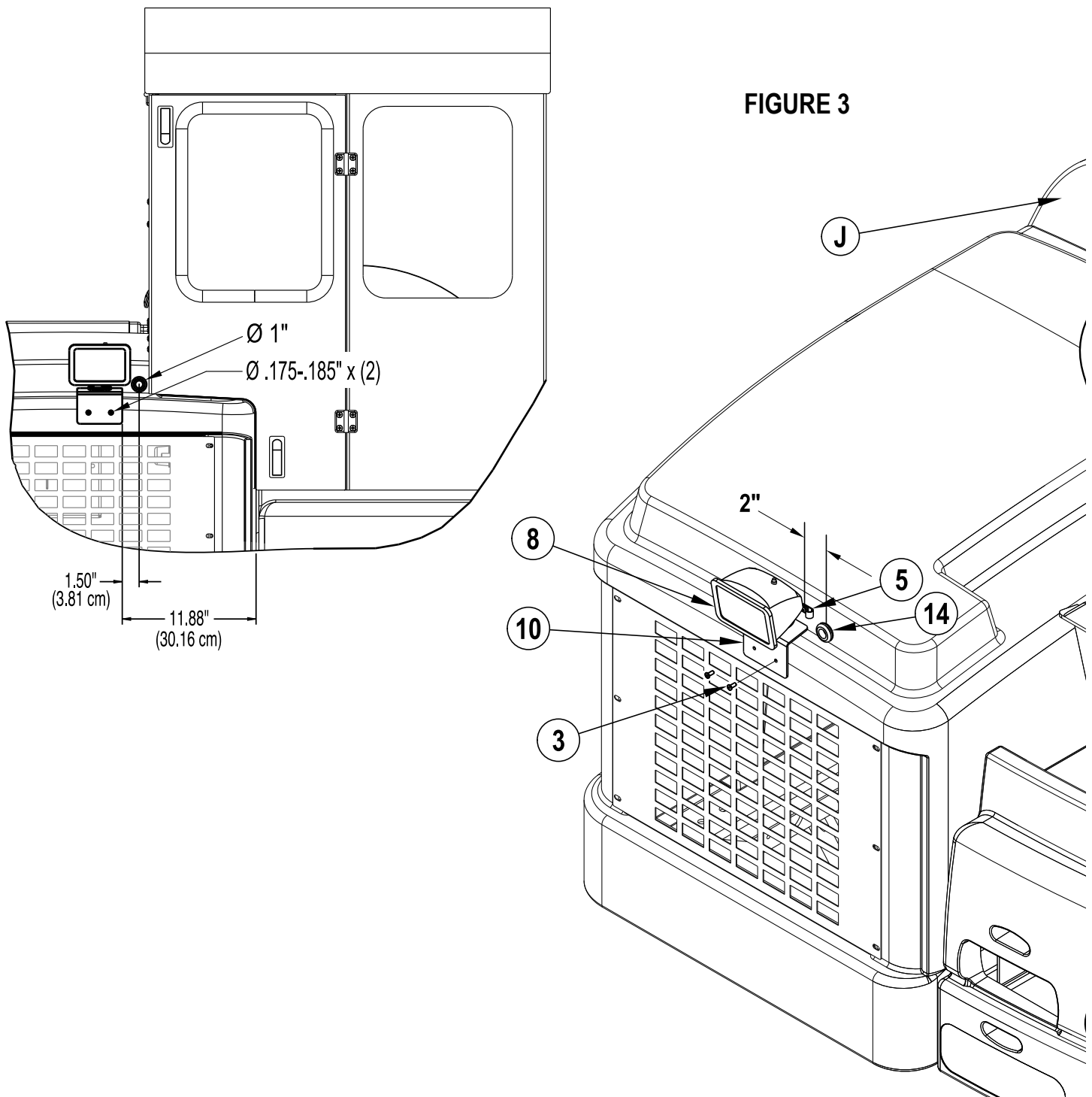
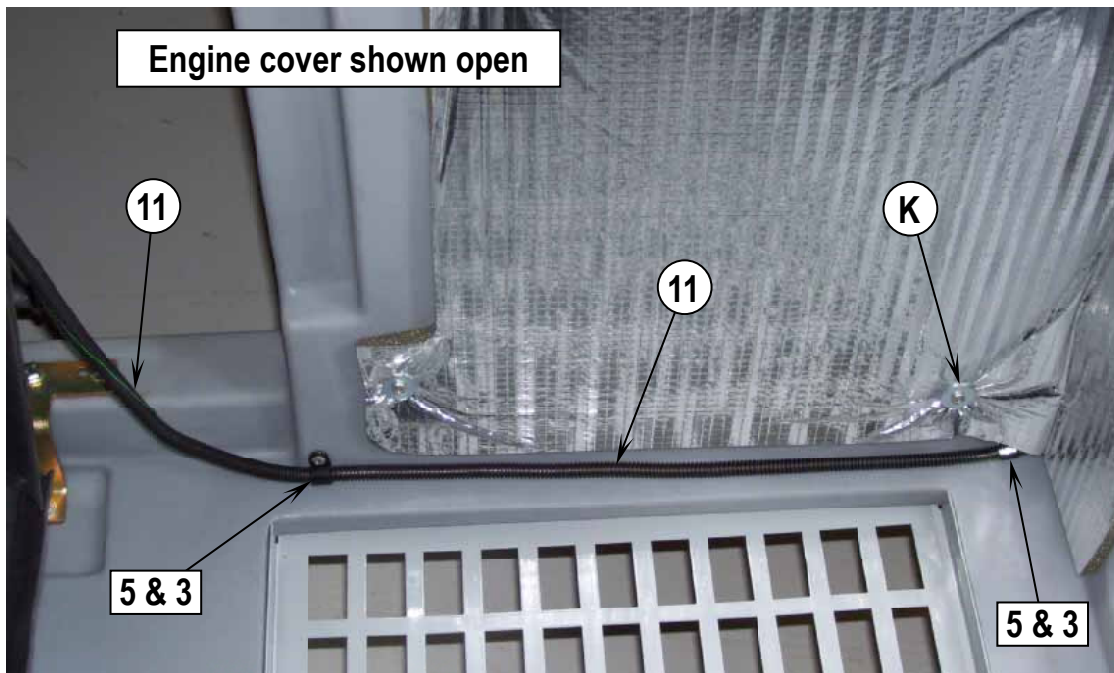

FIGURE 3

Rear Work Light Installation (continued)

- 15 See Photo 3. Remove the Screw and Washer (**K**) to access the \varnothing 1.00" hole drilled in the step above. Separate the upper portion of the harness (**11**) from the lower portion of the harness at the connector. Lift up the insulation and feed the upper portion of the harness to the \varnothing 1.00" hole and through to the outside of the engine cover.
- 16 Close the engine cover and plug in the end of the electrical harness (**11**) to the work light harness.
- 17 Mount the light and bracket to the machine using two of the Screws (**3**) and one of the P-Clamps (**5**) to hold the wiring harness in place.
- 18 Swing open the engine cover. Pull any excess harness through the hole, then replace the Washer and Screw (**K**). Use two of the P-Clamps (**5**) and Screws (**3**) at the locations shown (Photo 3) to secure the harness to the back inside corner of the engine cover (drill \varnothing .175-.185" pilot holes for the screws).
- 19 Reconnect the two portions of the harness at the connector.

PHOTO 3



Rear Work Light Installation (continued)

- 20 See Photo 4. Route the harness along the hydraulic hoses as shown. Secure the harness using wire ties. The harness is then routed under the hydraulic pump following other electrical harnesses (see Photo 5). Feed the harness under and behind the battery.
- 21 See Figure 4. Locate the grounding Screw (H) to the left and behind the battery, which is securing other ground wires.
- 22 Remove the Screw (H) and use it to secure the ring terminal on the BLK wire and all other wires which were grounded at this location.

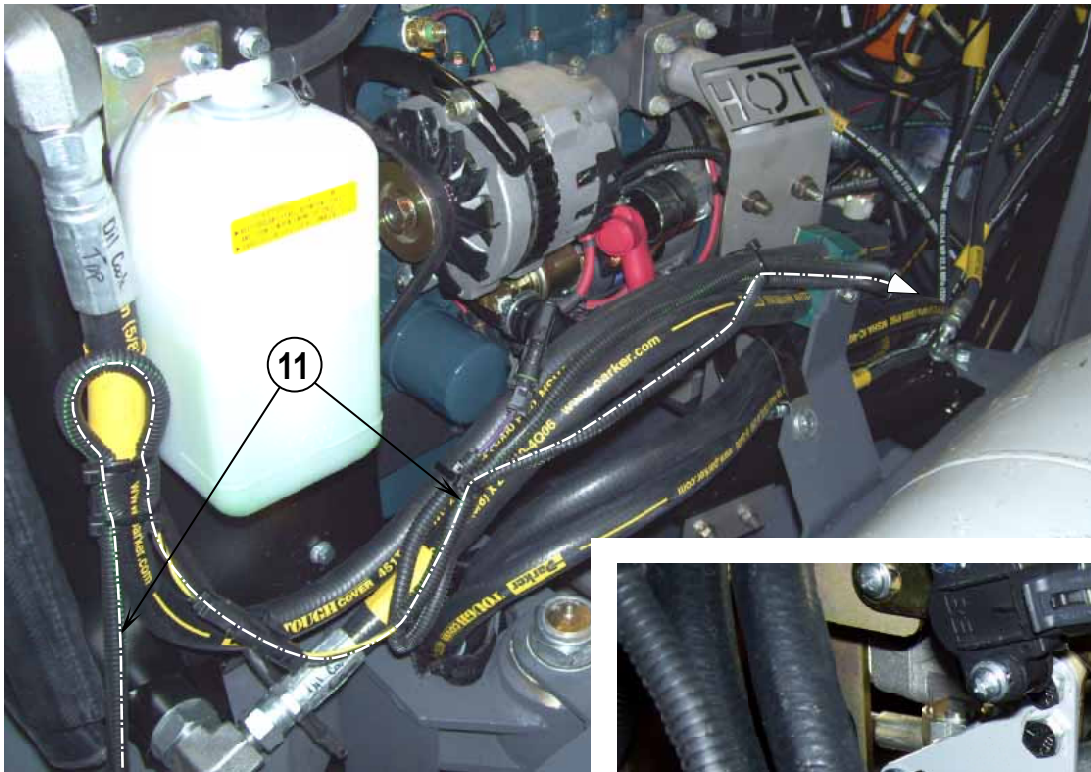
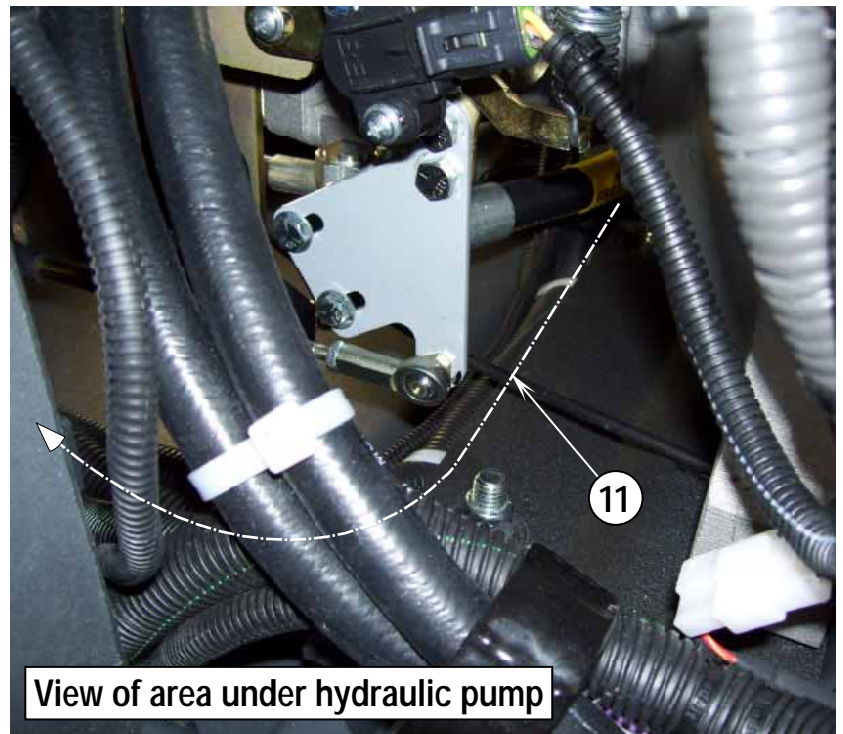

PHOTO 4

PHOTO 5



View of area under hydraulic pump

FIGURE 4

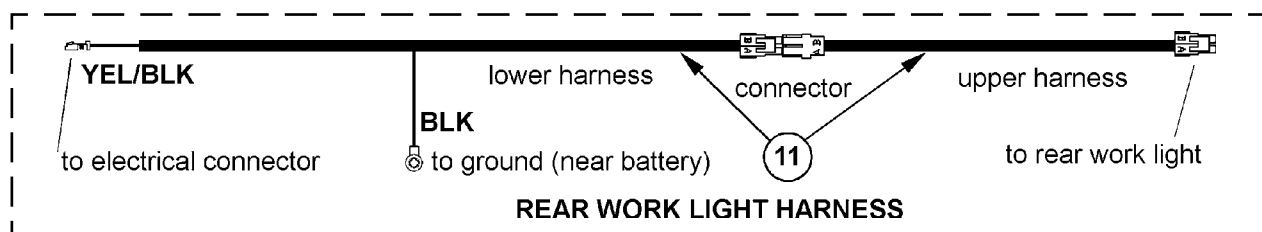
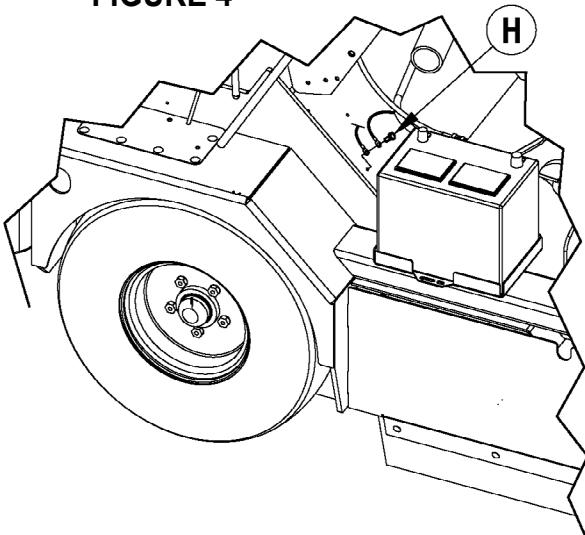

Rear Work Light Installation (continued)

- 23 See Photo 6. Route the remainder of the wiring harness (11) up along the frame, following other electrical harnesses up towards the hopper.
- 24 See Photo 7. The harness is then directed through Hole (L) over to the electrical connector (C) under the hopper.
- 25 See Figure 1. Locate the wire connector (C), slide off its Cover (E) and remove the Bus Bar (E1). Pull on the sides of the Cap (F) and slide the cap off of the connector. Remove one of the green dummy Plugs (G). Insert the pin on the end of the YEL/BLK wire into the now open slot, and reinstall the cap to lock the wire in place. Then reinstall the bus bar and cover onto the connector.
- 26 Secure the wiring harness to machine using wire ties so that it is out of the way of any moving parts.

PHOTO 6

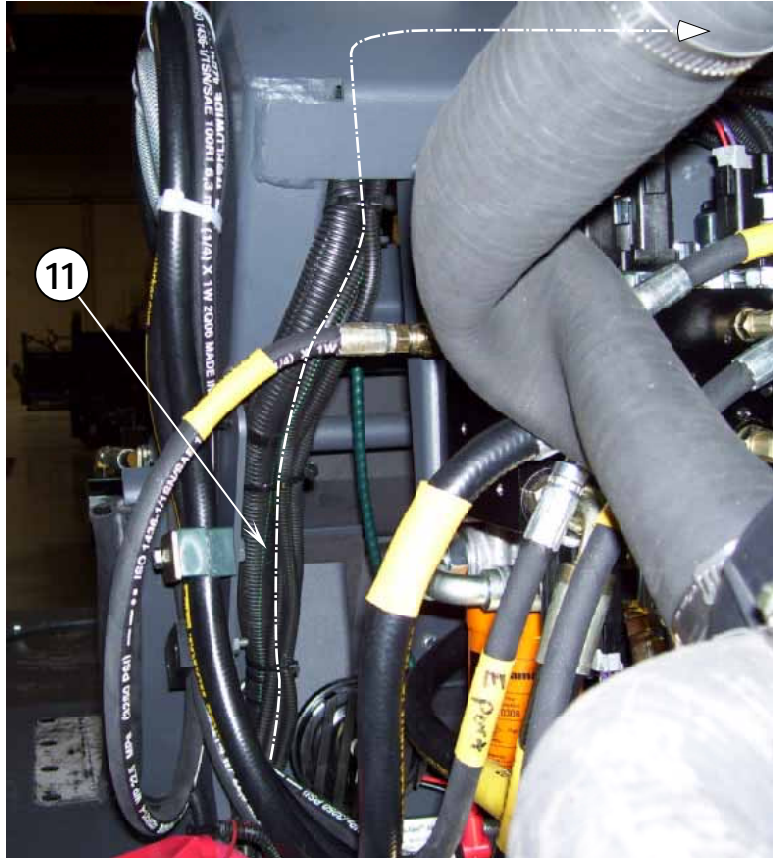
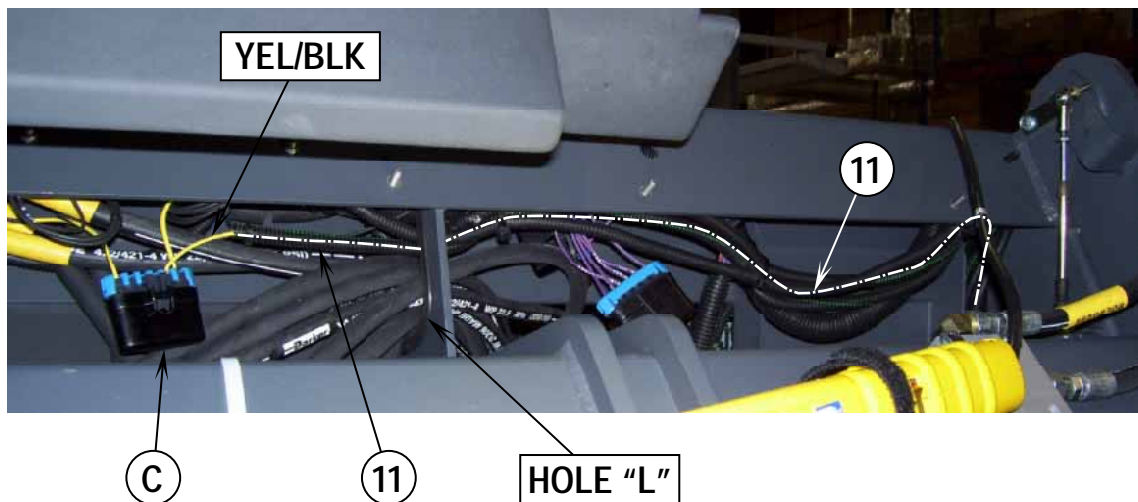
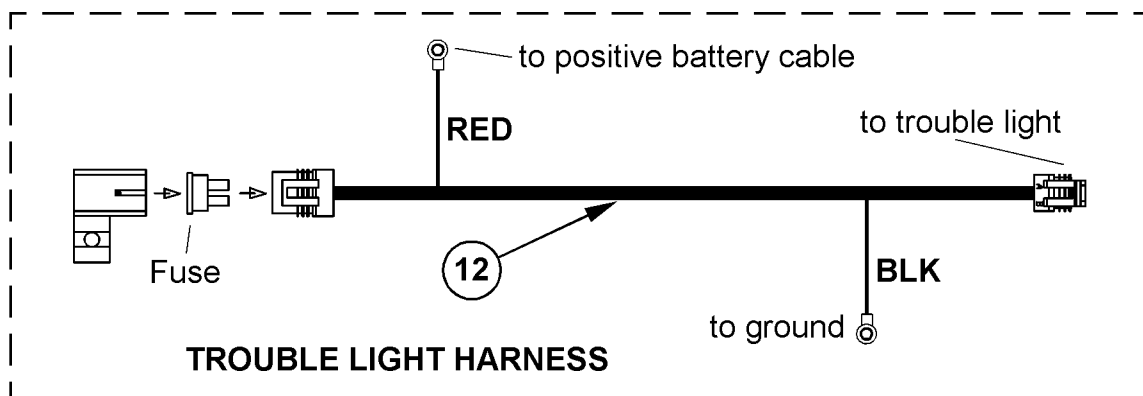
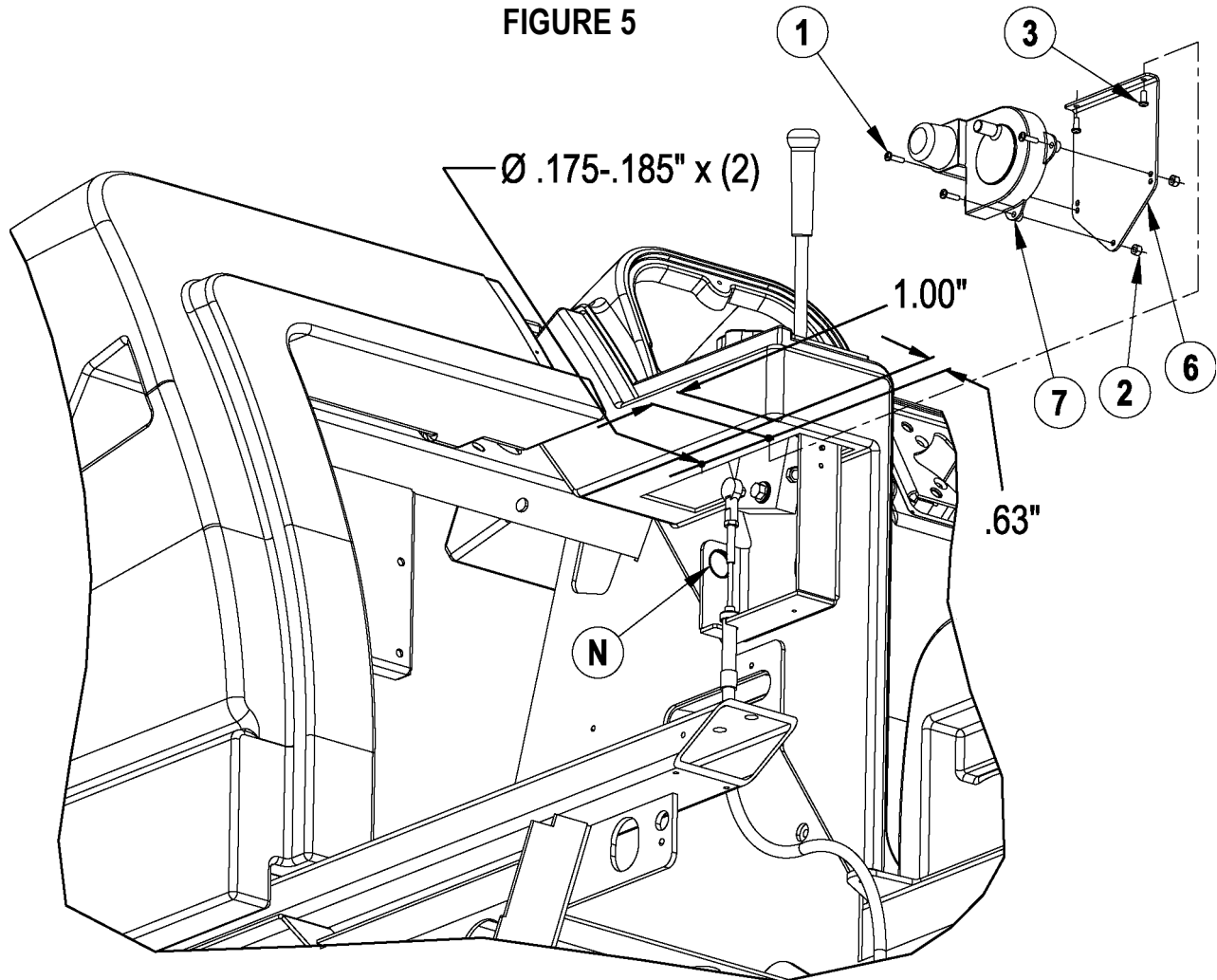

PHOTO 7



Trouble Lamp Installation

- 27 See Figure 5. Place the Light Mount Bracket (6) onto the machine at the location shown. Mark the hole locations and drill the two mounting holes using a $\text{Ø } .175\text{-.}185$ drill. Only drill through the outer layer of the roto-molded body panel.
- 28 Mount the bracket to the machine using two of the Screws (3).
- 29 Attach the light to the bracket using the three Screws (1) and Nuts (2).



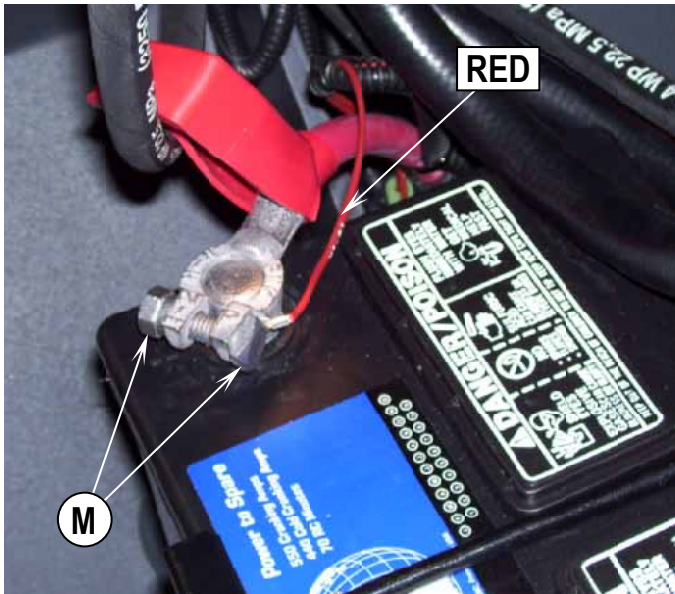

PHOTO 8

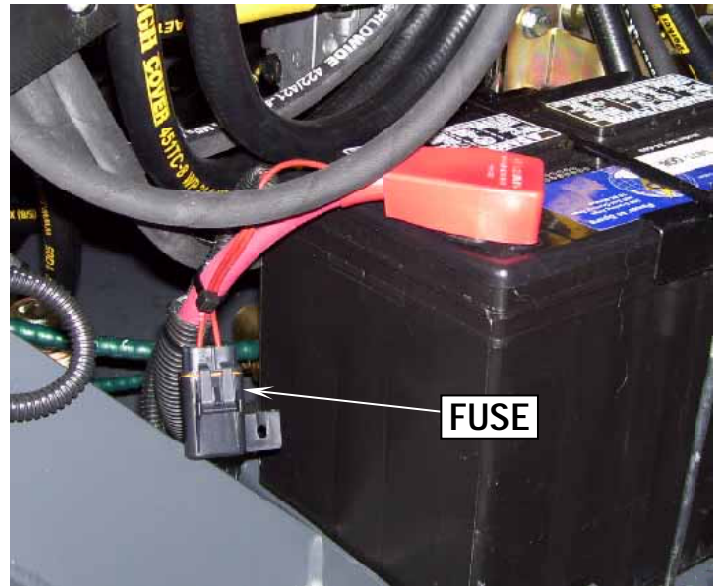

PHOTO 9

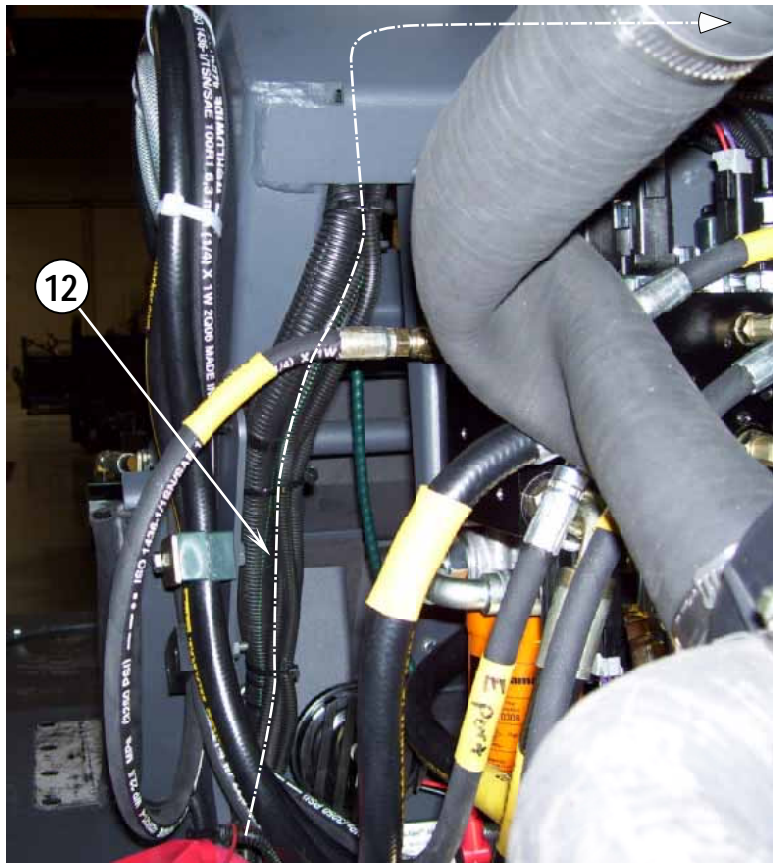

PHOTO 10

Trouble Lamp Installation (continued)

- 30 See Photos 8 and 9. The RED wire in the Trouble Lamp Harness (12) mounts to the positive battery cable. Lift up the rubber boot covering the positive battery post. Remove the Nut and Bolt (M) from the cable. Use the Nut and Bolt (M) to secure the ring terminal on the harness's red wire as shown. Do not over-tighten. Note: The Fuse and harness should be secured to the positive battery cable using a wire tie to keep it out of the way.
- 31 See Photo 10. Route the remainder of the wiring harness (12) up along the frame, following other electrical harnesses up towards the hopper.

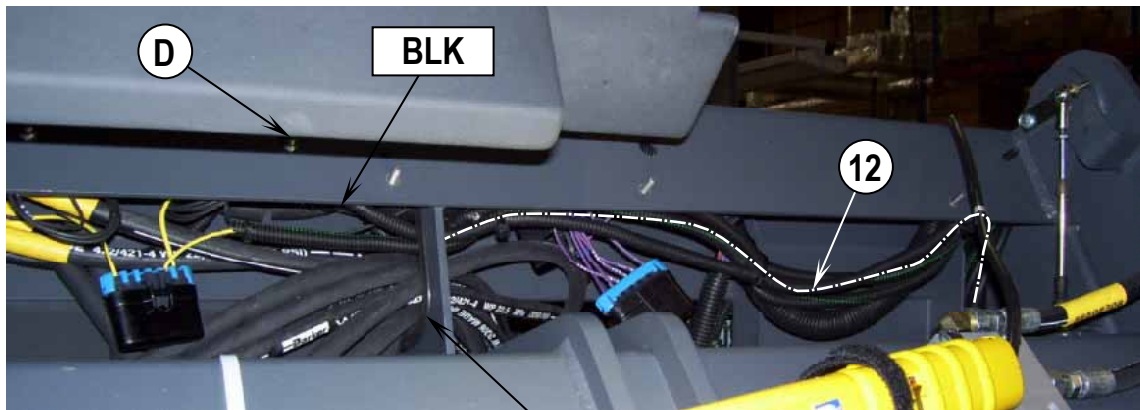
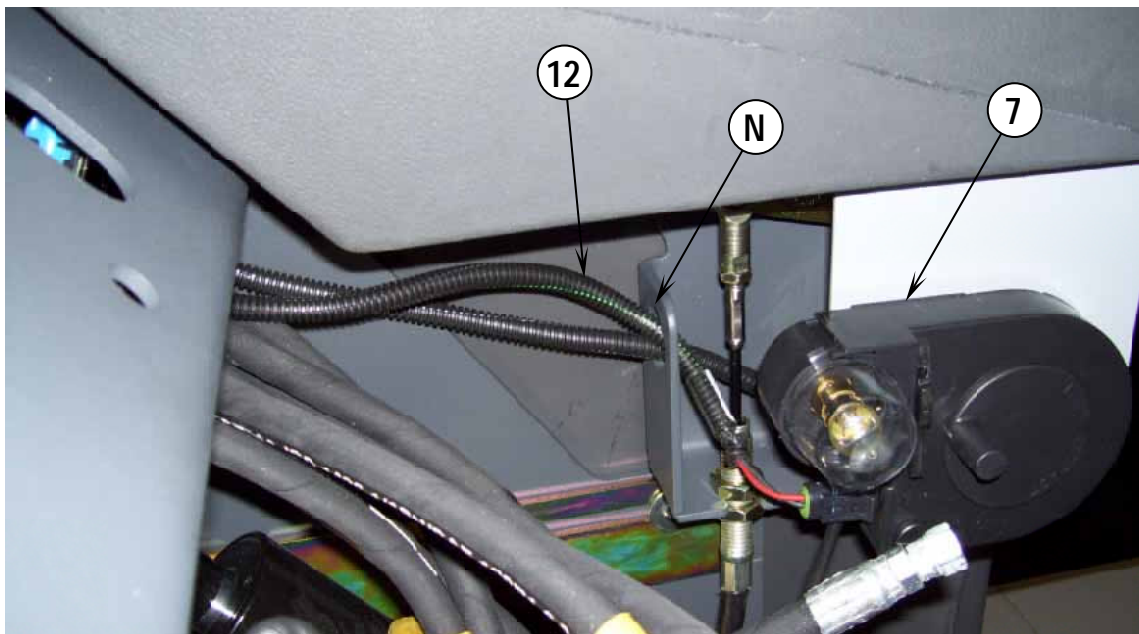

PHOTO 11

HOLE "L"

- 32 See Photo 11. The harness is then directed across the machine under the frame rail following other electrical harnesses. Route the BLK wire through the Hole (L). Remove the Screw and Nut (D) and use it to secure the ring terminal on the BLK wire and all other wires which were grounded at this location.
- 33 Route the remainder of the harness down along the frame to the trouble lamp. See Photo 12. Insert the connector end of the harness through the Hole (N) in the broom lift bracket. Connect the wiring Harness (12) to the Trouble Lamp (7). Secure the wiring harness to machine using wire ties so that it is out of the way of any moving parts.

PHOTO 12



- 34 **Test the lights for proper operation.**
- To turn on the two work lights (curb light and rear work light), the main key switch must be in the "ON" position and the headlight switch must be pressed to the on position. Each work light is then controlled at the lamp, by a push button switch.
 - To turn on the trouble light (in engine compartment), the key switch does not have to be "ON". Simply rotate the dial switch on the lamp to the "ON" position.
- 35 See Figure 1. Straighten the Rubber Cover (B) back into position and secure using the Wing Nuts and Washers (A).
- 36 Replace and close all covers and the seat. Start the engine and raise the hopper to the full up position. Push the hopper safety support handle forward to disengage, then lower the hopper. This completes the installation.

CONTENTS OF KIT

ITEM	PART NO.	QTY	DESCRIPTION
	56040897	1	Instruction Sheet
1	56002192	4	Scr, Pan Phil 10-24 x .75
2	56002768	3	Nut, Hex Nyl Loc 10-24
3	56003711	12	Scr, Pan Phil SS Plastite 10-14 x 0.62
4	56507678	1	Harness, Curb Light (Not Shown)
5	56172017	4	Clamp, P
6	56305626	1	Bracket, Light Mount
7	56305627	1	Trouble Lamp
8	56507830	2	Lamp 12v
9	56508468	1	Bracket, Work Light Mounting
10	56507834	1	Bracket, Light Mount
11	56507676	1	Harness, Rear Work Light (Not Shown)
12	56507677	1	Harness, Trouble Light (Not Shown)
13	56478246	10	Tie, Cable (Not Shown)
14	56760212	1	Grommet

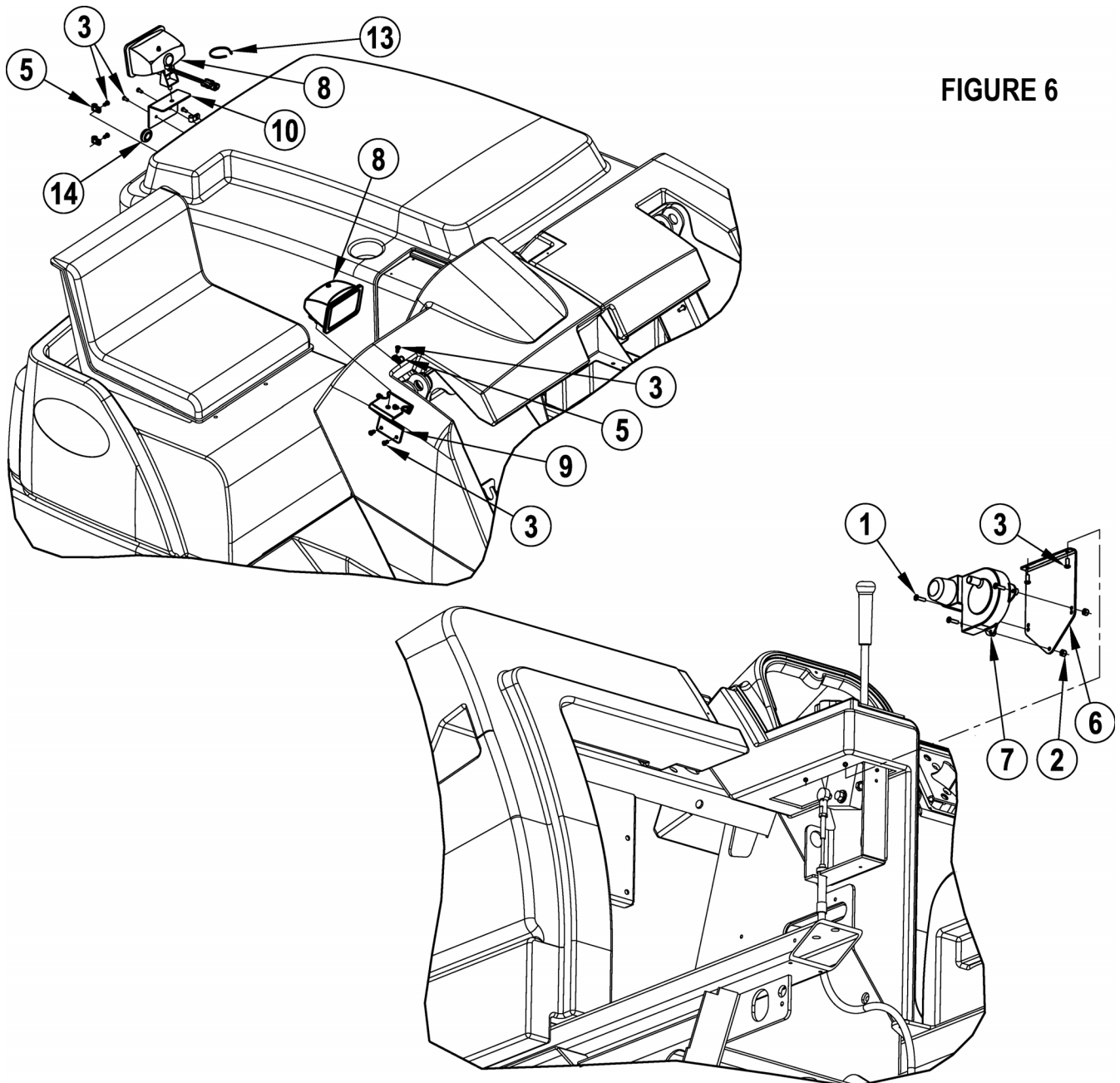

FIGURE 6